

Volleyball Floor Anchors - 501011

SUBMITTAL & INSTRUCTIONS

Specifications

501011 Floor Anchor—For Wood Floor Over Concrete

Product Description

Specify _____ floor anchors, manufactured by Draper, Inc., Spiceland, Indiana. One piece floor anchor shall be chrome-plated and designed for grout-in installation.

Anchors shall have spring-loaded flush fairings with standard 1/2"-13 NC threads.

Model 501011 shall be used for wood over concrete floors.

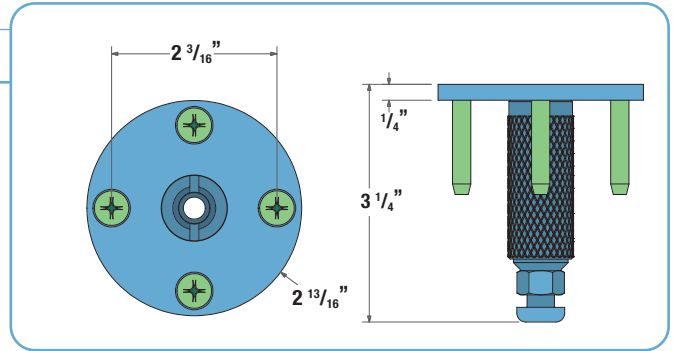

Section 1 - Before Beginning Installation

PARTS INCLUDED

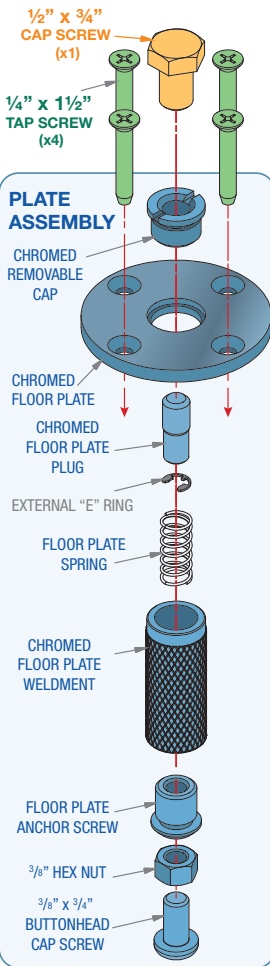

Also Included:

One 1oz. Bag of Set-45® Concrete Mix

OPEN PACKAGING

1. Confirm all parts shown at LEFT are present within the packaging.
2. Confirm all tools shown at RIGHT are available on the jobsite.

TOOLS REQUIRED



Section 2 - Floor Anchor Installation

Section 2.1 - Drilling Holes in Surface

1. Locate and mark center locations of FLOOR ANCHOR using provided layout diagram. Check these measurements for accuracy SEVERAL TIMES before proceeding.
2. Using a POWER DRILL with a 1 1/8" WOOD BIT, drill through the WOOD FLOOR and SUB-FLOOR.
3. Using a HAMMER DRILL with a 1 1/8" MASONRY BIT, drill the concrete to a minimum of 3 3/4" depth below playing surface.
4. Create a TEMPLATE using masonite or thick plastic. The TEMPLATE should be made so that the final routed circle has a diameter of 2 29/32". Use a scrap board for practice.
5. Route a counterbored hole 2 29/32" in diameter, and gradually increase the depth to 1/4".
6. Place PLATE ASSEMBLY in counterbored hole to ensure it is flush with floor.

Please Note: Keep constant downward pressure on the template to keep it from slipping, and to prevent the splintering of the Wood Floor.

7. Remove all dust and debris from the worksite.

IMPORTANT! 7. Fill the hole with water and scrub clean with a BOTTLE BRUSH.

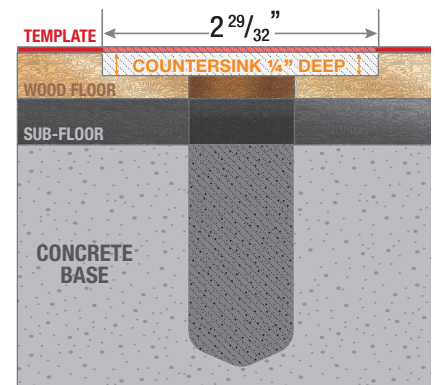
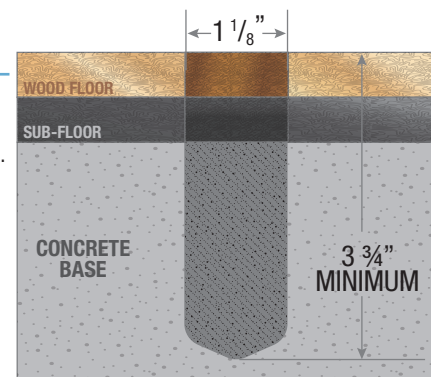

PROJECT: _____

ARCHITECT: _____

CONTRACTOR: _____

SUPPLIER: _____

DATE: _____ REVISED: _____

Volleyball Floor Anchors - 501011

SUBMITTAL & INSTRUCTIONS

Section 2.2 - Mixing SET-45 and Inserting Anchors

1. Mix **SET-45** (Included) in a **CLEAN MIXING CONTAINER** until it is a thick paste. For best results mix at a ratio of **½ OZ (15ML) WATER** with **1 BAG OF SET-45**.
2. Let mixture sit for 1 minute and then stir vigorously. Mixture will become more liquid.

Please Note: DO NOT add sand or concrete to mixture.

Please Note: DO NOT add too much water to or retemper concrete that has begun to set in the mixing container. Final results will be a failure.

3. Turn **CAP SCREW** onto Floor Plate until it is finger tight.
4. Pour **SET-45 MIXTURE** into hole until $\frac{3}{4}$ full.
5. Dip the **FLOOR PLATE ASSEMBLY** in water up to the **CHROMED FLOOR PLATE**.
6. Slowly lower the **FLOOR PLATE ASSEMBLY** into the mixture until it is properly seated into the counterbored hole and flush with playing surface.
7. Remove excess **SET-45 MIXTURE** using a **PUTTY KNIFE** and **PAPER TOWELS/RAG**.

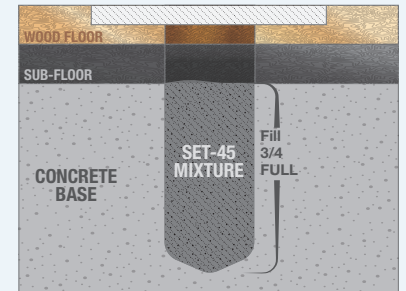
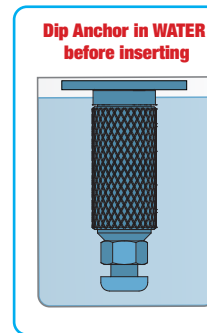
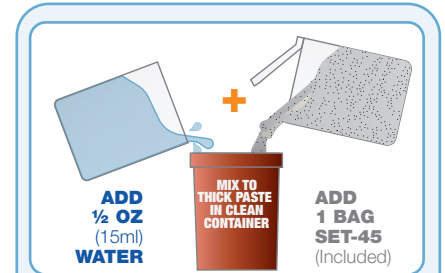

Section 2.3 - Securing Anchors to Floor

1. Using a $\frac{5}{32}$ " DRILL BIT, drill 4 holes to a depth of 1 $\frac{5}{8}$ " deep to receive the provided **SCREWS**.
2. Insert and tighten **SCREWS** until they are flush with **FLOOR PLATE**.
3. After 15 minutes, the cement and **FLOOR PLATE** will be set. Carefully remove the **CAP SCREW**.
4. **Allow cement to set for 12 hours prior to use.**

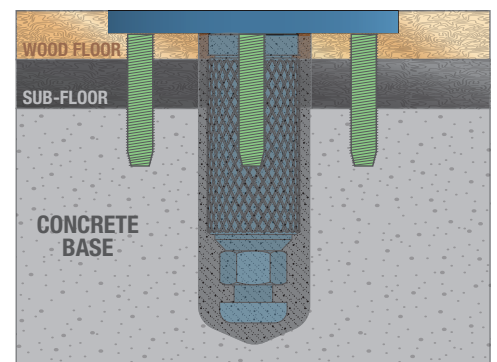
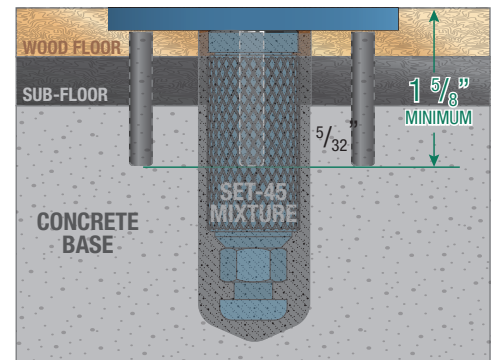

PROJECT: _____

ARCHITECT: _____

CONTRACTOR: _____

SUPPLIER: _____

DATE: _____ REVISED: _____